

# HELLGATE HIGH SCHOOL

## Option S.2 - Start Over

- Remodel majority of existing school
- Modify Gerald Avenue to improve pick-up/drop-off
- Security cameras
- Acoustical improvements to 1940's gym

Missoula County  
Public Schools  
Facilities Strategic Plan

Hellgate High School  
Site Area: 3.12 acres  
Parking Spaces: 75

### Building Square Footage

Existing	245,694
New	7,000

**Total Project Cost**  
\$17,040,133

**Replacement Cost**  
\$60,000,000

**Ratio** 28%

Good

Fair

Poor

Replace

**Remaining Deferred  
Maintenance & Energy  
Project Costs**  
\$0

**Current Annual Energy Costs**  
\$200,000

**Potential Energy Savings**  
\$0

**Rental/Lease/Sale Income**  
None

**Current Enrollment**  
1,258

**Future Peak Enrollment**  
1,382

**Capacity** 1,500-1,800

Costs include construction, demolition (where applicable), technology, furnishings, site development, design fees, site acquisition (where applicable), contingency and escalation to January 2020





# HELLGATE HIGH SCHOOL

- Option S.2 - Start Over
- Remodel majority of existing school
  - Modify Gerald Avenue to improve pick-up/drop-off

Missoula County  
Public Schools  
Facilities Strategic Plan

Hellgate High School  
Site Area: 3.12 acres  
Parking Spaces: 75

**Building Square Footage**  
Existing 245,694  
New 7,000

**Total Project Cost**  
\$17,040,133

**Replacement Cost**  
\$60,000,000

**Ratio** 28%

Good

Fair

Poor

Replace

**Remaining Deferred  
Maintenance & Energy  
Project Costs**  
\$0

**Current Annual Energy Costs**  
\$200,000

**Potential Energy Savings**  
\$0

**Rental/Lease/Sale Income**  
None

**Current Enrollment**  
1,258

**Future Peak Enrollment**  
1,382

**Capacity** 1,500-1,800

Costs include construction, demolition (where applicable), technology, furnishings, site development, design fees, site acquisition (where applicable), contingency and escalation to January 2020

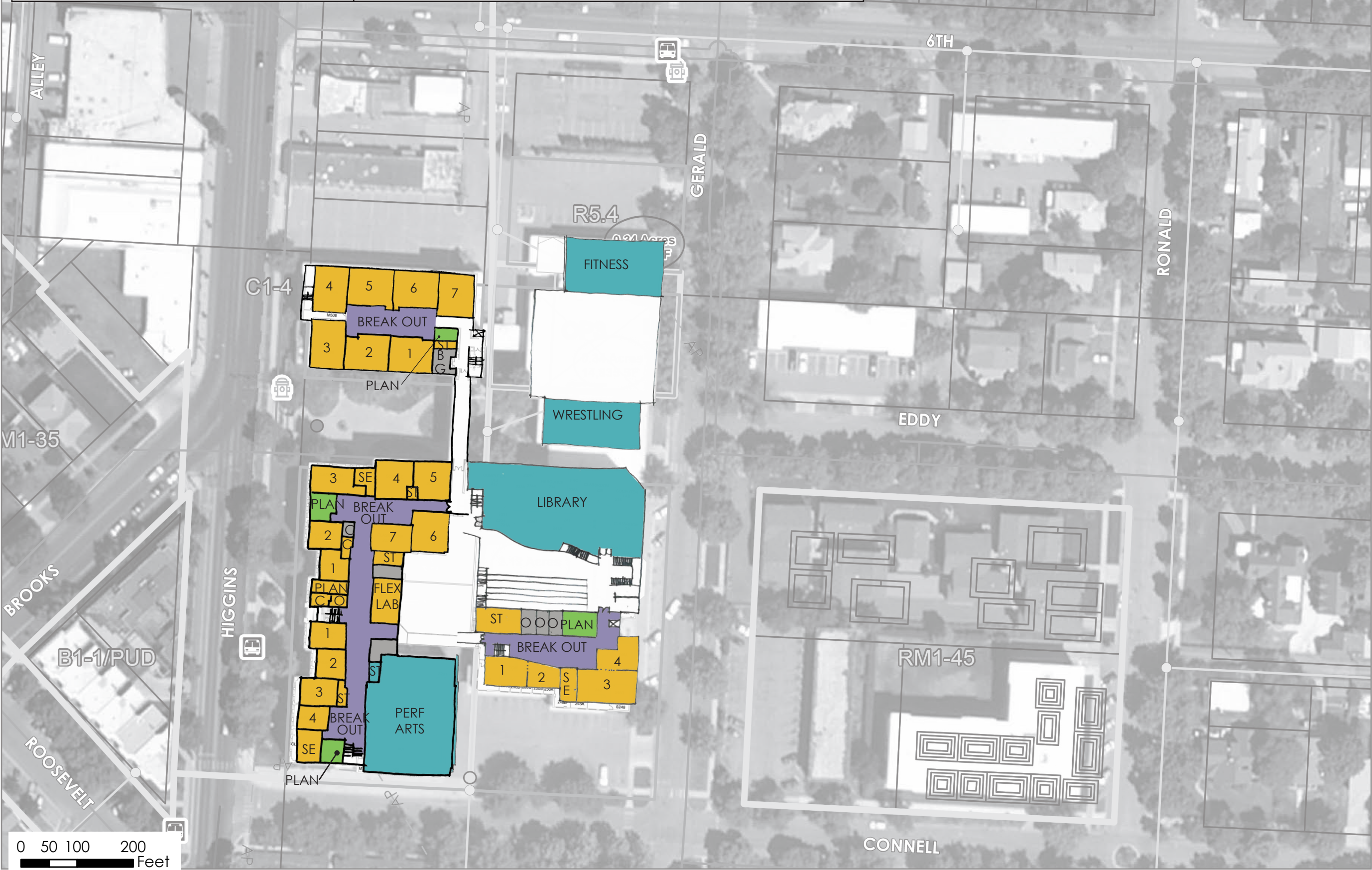



# HELLGATE HIGH SCHOOL

- Option S.2 - Start Over
- Remodel majority of existing school
  - Modify Gerald Avenue to improve pick-up/drop-off

Missoula County  
Public Schools  
Facilities Strategic Plan

Hellgate High School  
Site Area: 3.12 acres  
Parking Spaces: 75

**Building Square Footage**

Existing	245,694
New	7,000

**Total Project Cost**  
\$17,040,133

**Replacement Cost**  
\$60,000,000

**Ratio** 28%

Good  
**Fair**  
Poor  
Replace

**Remaining Deferred  
Maintenance & Energy  
Project Costs**  
\$0

**Current Annual Energy Costs**  
\$200,000

**Potential Energy Savings**  
\$0

**Rental/Lease/Sale Income**  
None

**Current Enrollment**  
1,258

**Future Peak Enrollment**  
1,382

**Capacity** 1,500-1,800

Costs include construction, demolition (where applicable), technology, furnishings, site development, design fees, site acquisition (where applicable), contingency and escalation to January 2020

